

MAINTENANCE INSTRUCTIONS

For Chemline Gate Valves 8" - 14" (Handwheel & Nut Styles)

Maintenance

Refer to ASSEMBLY DRAWING CGA-1 rev 0. And proceed as follows:

1. To disassemble valve loosen the bolts, nuts (12) and washers (14) from the bonnet (4) and remove from stem (3).

Important: The disc (2) fits very tightly into the body (1) making disassembly difficult in the closed position. Always have valve in the OPEN position when performing maintenance.

2. Lift disc (2) out of body (1) and remove O-Ring (7).
3. To remove the handwheel (6) loosen and remove the set nut (14). Handwheel style.
4. To remove Cap (6) loosen and remove set screw (16). Nut style.
5. After removing the indicator cover (18) and the indicator pin (19), the indicator ring (17) is removed by inserting the indicator pin (19) into the slot in the indicating ring (17) and turning. Handwheel style.
6. To free stem from (3) from stem support (5) remove thrust bearing (8) and O-Rings (10 & 11).
7. Lubricate the thrust bearing (8) and O-Rings (10 & 11) with Dow Silicone Compound III or equivalent.
8. To re-assemble valve reverse steps 1 to 6 above.
9. Set the red line on the indicating ring (17) to the lowest line of the indicator cover (18) by using the indicator pin (19) as described in section 5. Handwheel style.

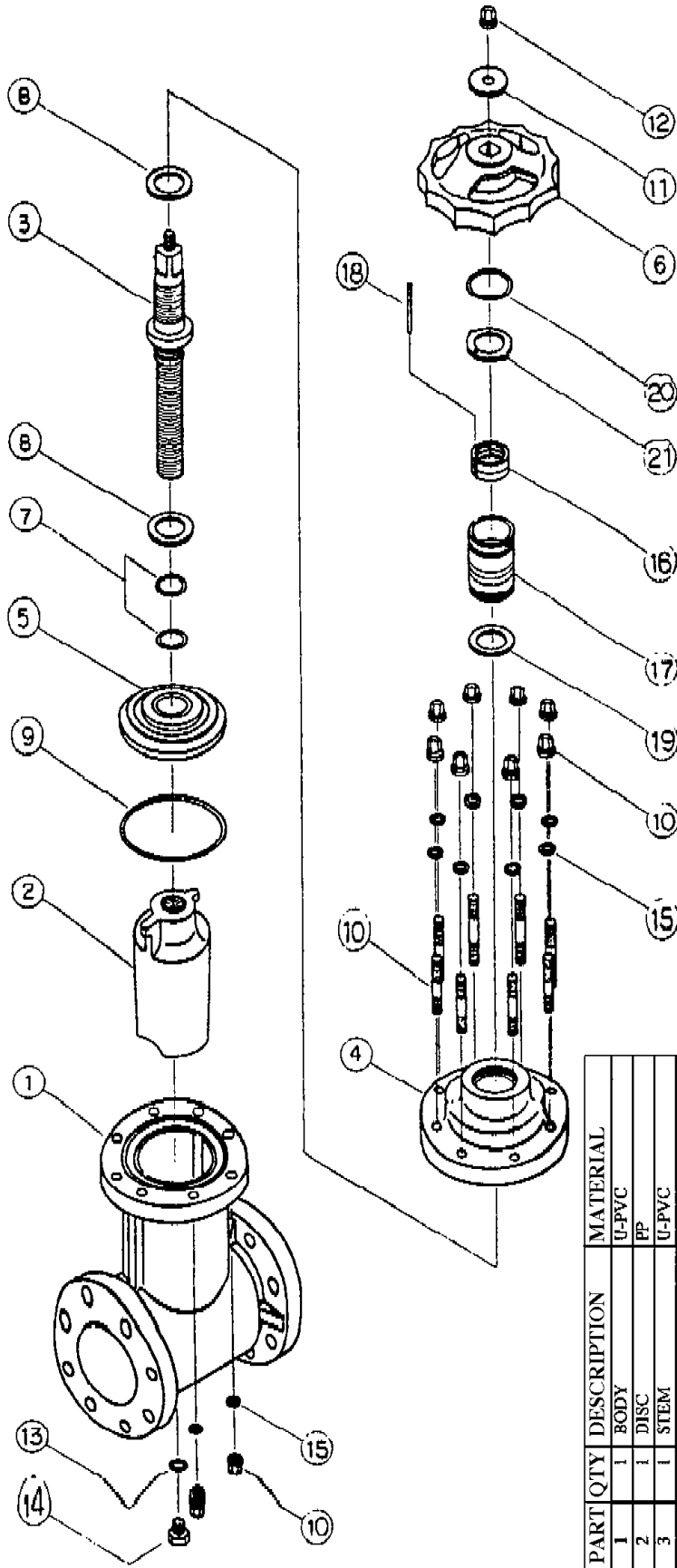

PART	QTY	DESCRIPTION	MATERIAL
1	1	BODY	U-PVC
2	1	DISC	PP
3	1	STEM	U-PVC
4	1	BONNET	U-PVC
5	1	STEM SUPPORT	U-PVC
6	1	HAND WHEEL	PP
7	2	O-RING	EPDM
8	2	THRUST RING	PTFE (teflon)
9	1	O-RING	EPDM
10	1	BOLTS & NUTS	VARIOUS
11	1	WASHER	U-PVC
12	1	SET NUT	VARIOUS
13	1	GASKET	EPDM
14	1	DRAIN PLUG	U-PVC
15	1	WASHER	304 S.S.
16	1	INDICATOR RING	U-PVC
17	1	INDICATOR COVER	POLYCARBONATE
18	1	GUIDE PIN	304 S.S.
19	1	CUSHION	EPDM
20	1	O-RING	EPDM
21	1	GUIDE PIN HOLD	U-PVC

TITLE		CHEMLINE GATE VALVES		SCALE	DATE	CHEMLINE PLASTICS CHEMLINE	
REFERENCE		HANDWHEEL MODELS 1-1/2-6"		DR. BY		DWG. NO.	OGA-2
				CHKD. BY		REV.	0
				APP. BY			